

REV	CHANGED	DATE	CHANGE	X	Y

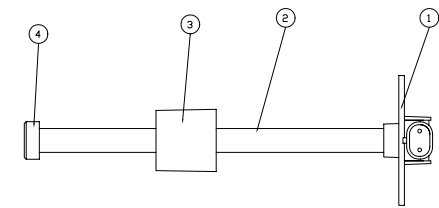
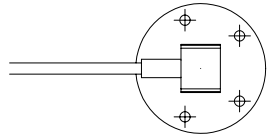
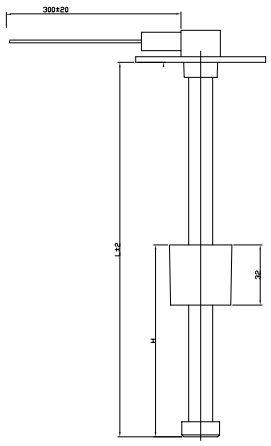
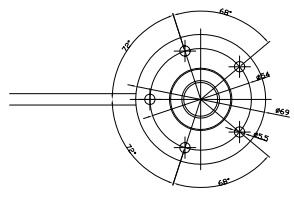

SIGNAL OUT
R (ohm)
Normally 0-180 ohm

SPECIFICATIONS.

- Can be mounted in steel-, aluminum- and plastic-tank.
- Electrical components: Pmax = 300 mW
- Workingtemperature: -40°C to +70°C
- Can be used in Arctic diesel
Diesel (DIN EN 590)
RME (DIN V 51606)
- and additives of: Gasoline
Kerosene
Methanol
Ethanol
- Vibration: 0,0031 g / Hz starting at 6 Hz rising to 0,025 g / Hz at 12 Hz and to full input 0,05 g / Hz at 18 Hz to 150 Hz.
- Orientation: Sensor mounted in fixture standing, as they would be in a truck.
- Vibration axis: All XYZ (3 x 180 deg rotating)
- Duration: 3 x 16 h

SPECIFICATIONS.

- Can be mounted in steel-, aluminum- and plastic-tank.
- Electrical components: Pmax = 300 mW
- Workingtemperature: -40°C to +85°C
or max 1 hour +95°C in air
- Can be used in Arctic diesel
Diesel (DIN EN 590)
RME (DIN V 51606)
- and additives of: Gasoline
Kerosene
Methanol
Ethanol

WEMA ART. NO.	
LENGTH (L)	350 mm
GASKET FOR TANK	2 mm

REV	BY	DATE	TYPE	DRWG. NO.	MATERIAL	QTY	MATERIAL SPEC.
4					STAINLESS STEEL, AISI 316		
3				021301	N/A		
2					STAINLESS STEEL, AISI 316		
1				001305	STAINLESS STEEL, AISI 316		

PROJECT:	ART. NO.	SCALE:
DATE:	TOLERANCE: R = S R	SCALE:
DRW. NO.:	DRAWING SENSOR TYPE SS	
ISSUE:	DRAWING NO. ART. NO. REF.	ISSUE:
ISSUE:	ISSUE:	ISSUE:

TOLERANCE FLUCT. DESCENDING: ± 5% TOLERANCE RESISTANCE vs. TEMP ± 100ppm
RESISTANCE TOLERANCE AT 20°C: Rout ± (1,5 ohm + 5% of Rout)