

issue	date	change - ch.note no.	draw	check
01	X	X	X	X

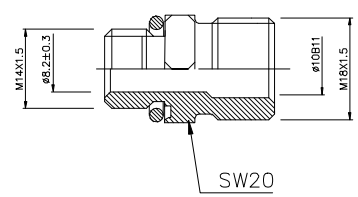

M18X1.5 / M14X1.5
ART. NO. 006133

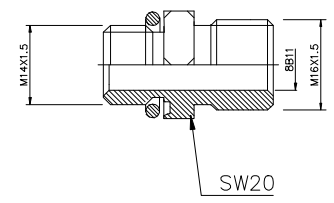

M16X1.5 / M14X1.5
ART. NO. 006134

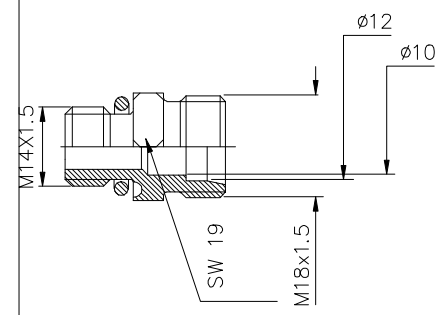

M18X1.5 / M14X1.5
ART. NO. 006010

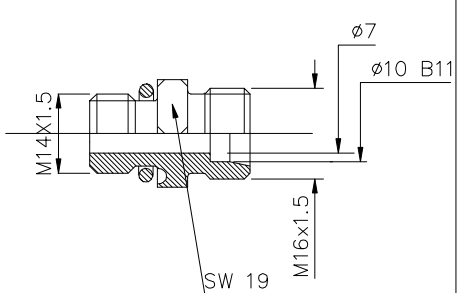

M16X1.5 / M14X1.5
ART. NO. 006011

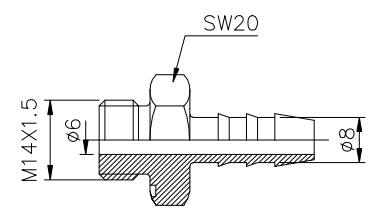

M14X1.5 / ø8
ART. NO. 006550

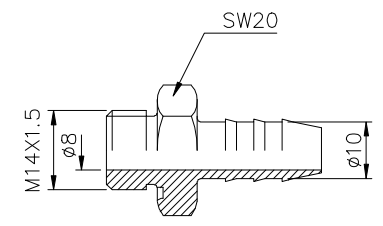

M14X1.5 / ø10
ART. NO. 006555

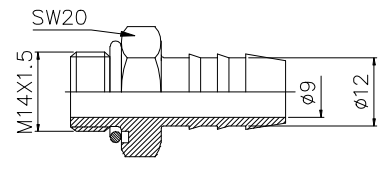

M14X1.5 / ø12
ART. NO. 006556

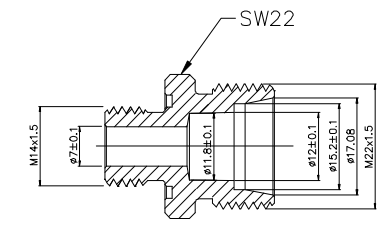

M22X1.5 / M14X1.5
ART. NO. 006560

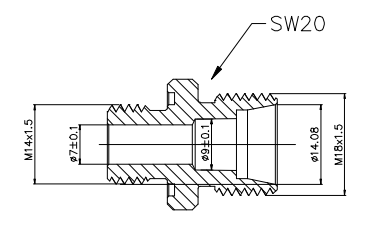

M18X1.5 / M14X1.5
ART. NO. 006565

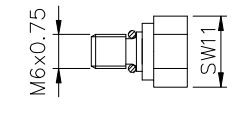

M6X0.75 / CLOSED
ART. NO. 006201

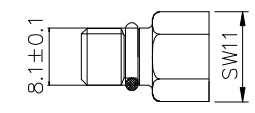

M8X1 / CLOSED
ART. NO. 006144

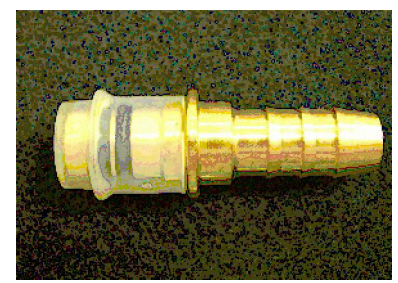

NTU 503 1/2" / ø9,3
ART. NO. 006700



NTU 503 5/8" / ø13,6
ART. NO. 006701

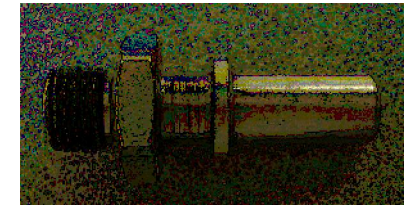

SW 22
M14x1,5/ ø11,8
ART. NO. 006000

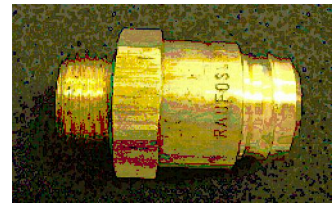

SW 22
M16x1,5/ ø12,5
ART. NO. 006007

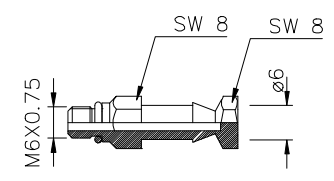

M6X0.75 / ø6 CLOSED
ART. NO. 006138

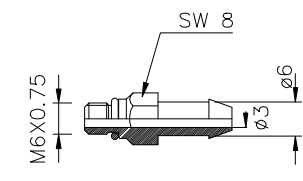

M6X0.75 / ø6
ART. NO. 006139

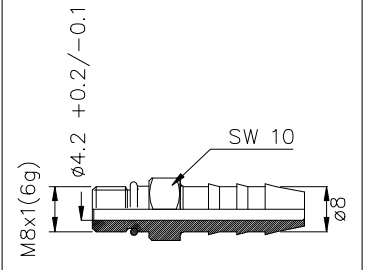

M8X1 / ø8
ART. NO. 006526

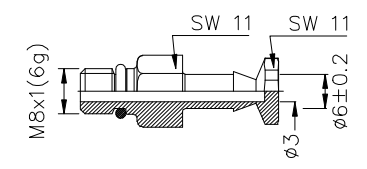

M8X1 / ø6 CLOSED
ART. NO. 006143

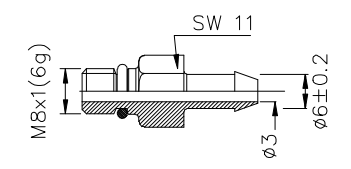

M8X1 / ø6
ART. NO. 006145

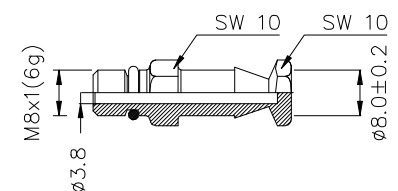

M8X1 / ø8 CLOSED
ART. NO. 006149

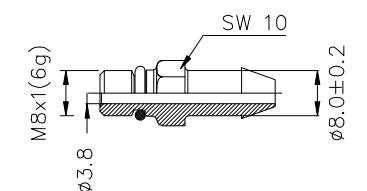

M8X1 / ø8
ART. NO. 006148

All proprietary rights reserved by WEMA-SYSTEM AS. This drawing is not to be reproduced or in any way utilized for the manufacture of a component or unit herein illustrated, and may not be released to other parties, without written consent by WEMA-SYSTEM AS. Any infringement will be legally pursued. Site of court is Bergen, Norway.

PROJECT: TX3		TOLERANCE: ISO 2768 m	SURFACE ROUGHNESS: R _a = 25	PROJ. 	SCALE: 1:1
DRAW.	DATE: 07-12-20	Name MRI			
CHECK		ALL WEMA BRASS FITTINGS			
STAND					
WEMA-SYSTEM A/S BERGEN - NORWAY		DRAWING NO, ART. NO./REF: FITTINGS		ISSUE: PAGE: 1	
ORIGIN		REPLAC. FOR:		REPLAC. OF:	